

## BB Encastré 2.0

- Recyclable
- CO2 reduction
- Energy Efficiency
- Vandal Resistant IK10
- Protection class IP66
- Maintenance free
- Recyclable Materials
- LED Technology
- Plug & play installation
- DALI communication
- Glare Free
- Extreme long lifetime

### Product description

The BB Encastré 2.0 includes a continuous light line made of polycarbonate tubes with an aluminium component housing. The fixture can easily be mounted semi-recessed into walls and specified areas and sealed by an aluminium frame.

A LED strip emits light into an IK10+ impact-proof polycarbonate tube with a diffuser of 20% so no LED bulbs are visible.

The 180° light distribution increases the feeling of comfort by illuminating the whole space including the ceiling. This contributes to a feeling of safety in large areas such as subway and railway stations, airports, sports halls, football stadiums, public area, etc.

### Specifications

Input voltage	220 – 240 Vac
Frequency	50 / 60 Hz
Power factor	0,98 (100%)
Dim range	10 to 100% by DALI
Driver lifetime	100.000 hours
Insulation	Class II
Operation temp.	-25°C ~ +40°C
Wiring	Low Smoke Zero Halogen, 1-phase trough-wired, terminal black

### Construction

Luminaire parts	extruded anodized aluminium
Light tube	100/96mm Polycarbonate, UV stable
Power supply	Ebox: external installed Philips Xitanium LED driver – 40W or 75W set to 300 mA
Fixing	Semi-recessed into the wall framed in aluminium anodised profiles
Light source	2835 mid-power LED
LED lifetime	L80B50 = 100.000 hours
Light color	4000K
CRI	80

[www.bblightpipe.com](http://www.bblightpipe.com)



member of the TKH Group

# BB Encastré 2.0

**BB**  
Lightpipe

## Certifications

Protection class	IP66
Impact class	IK10+ (150 Joule)
Certificate	ENEC 71-104428
Standards	EN 60598-1, EN 60598-2-2, EN 55015, EN 61000-3-2
All wires	Low Smoke Zero Halogen
Sustainability	Fully recyclable components

## Light Distribution

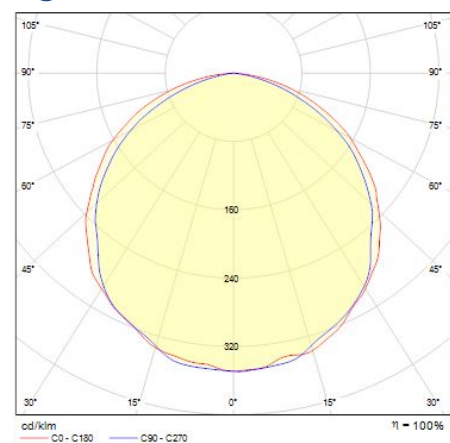

## Dimensions

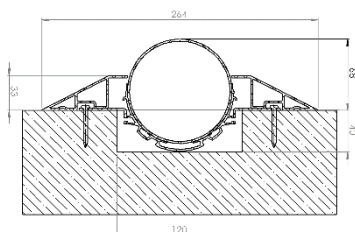

### BBENC1M

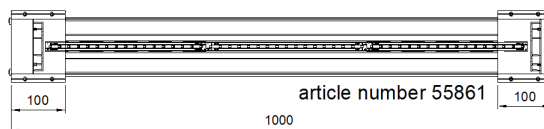

External Driver LED Xitanium 40 W  
Output voltage 25...77V, Output current 200...700 mA

Driver output current set to 300 mA

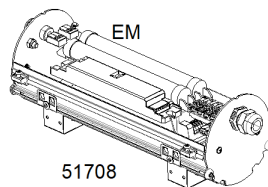
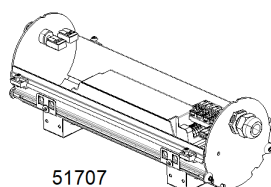

LED -  
LED +  
LIHH 2x0,75-OB Cca-s1,d2,a1  
Length to be defined

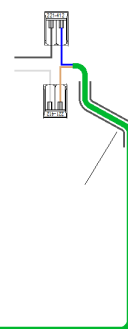

### BBENC2M

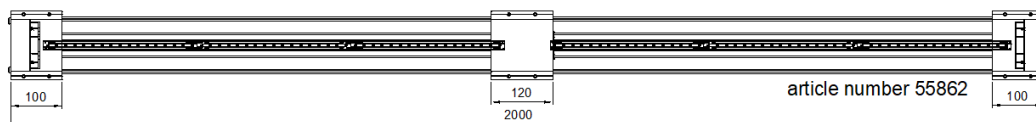

External Driver LED Xitanium 75 W  
Output voltage 50...150V, Output current 200...700 mA

Driver output current set to 300 mA

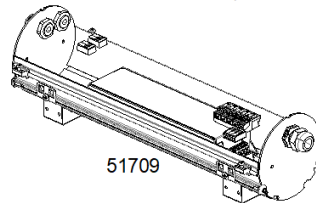
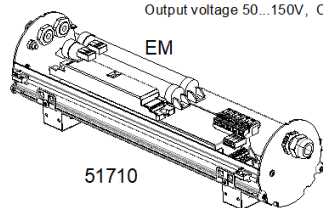

LED -  
LED +  
LIHH 2x0,75-OB Cca-s1,d2,a1  
Length to be defined

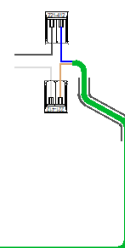

## BB Ebox:

External Ebox: aluminium casing with driver external placed, up to 16m from the BB Encastré 2.0.

## Types and dimensions

Type	Length	Power	Weight	Lumen	efficiency	Distribution	Driver & driver housing
BBENC1M	100cm	15 W	3 kg	1836 lm	120 lm/W	Symmetric	Ebox 304mm – External installed driver
BBENC2M	200cm	30 W	3 kg	3672 lm	120 lm/W	Symmetric	Ebox 404mm – External installed driver

[www.bblightpipe.com](http://www.bblightpipe.com)



member of the TKH Group